

ORDINANCE OF THE LAPORTE COUNTY  
BOARD OF COMMISSIONERS

NO. 94-1

WHEREAS, the Board of Commissioners of LaPorte County is responsible for formulating County Road policy consistent with the Statutes of the State of Indiana; and,

WHEREAS, the Board of Commissioners of LaPorte County recognize that a hazardous situation exists and have decided, therefore, that it is necessary to establish a forty (40) miles per hour speed zone on C.R. 150 West in Scipio Township; and,

WHEREAS, the Board of Commissioners of LaPorte County have the authority under Indiana Code 9-4-1-58 to establish the rate of speed on designated roadways;

IT IS THEREFORE ORDAINED:

1. That pursuant to Indiana Code 9-4-1-58 it shall be unlawful for any vehicle to exceed forty (40) miles per hour on C.R. 150 West from its intersection with C.R. 250 South to the intersection of said road with C.R. 500 South in Scipio Township;
2. That the LaPorte County Highway Department is hereby directed and ordered to post said road with signs indicating forty (40) miles per hour;
3. That after the roadway has been posted in accordance with paragraph 2, herein, it shall be an infraction under Indiana Code 9-4-1-58 for any person to violate this ordinance.

BOARD OF COUNTY COMMISSIONERS  
LAPORTE COUNTY, INDIANA

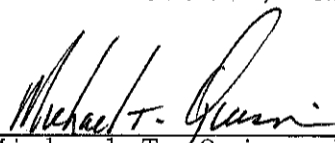
  
\_\_\_\_\_  
Michael T. Quinn, President

  
\_\_\_\_\_  
Norman E. Pahs

  
\_\_\_\_\_  
Stephen J. Wurster

Passed this 10<sup>th</sup> day of January, 1994.

Attest:   
\_\_\_\_\_  
Michael R. Schultz, County Auditor

Please publish two (2) times in the Michigan City News-Dispatch and the LaPorte Herald-Argus on Monday, January 17 and Monday, January 24, 1994.

SUBDIVISION	ROAD	SECTION
ANDERSON PARK	GREENLAWN DR.	24
DOOR VILLAGE ADDIT	"	16
GLENDALE	BRYANT DR.	13
"	CURTIS DR.	"
"	MORGAN DR.	"
"	POWELL DR.	"
"	MAPLE LEAF LN.	3
HARTMAN'S	"	"
LAWDALE	MAYFLOWER RD.	"
LINCOLN GARDENS	"	"
MEADOWVIEW ESTATES	RUTH AVE	13
PINOLA ESTATES	"	8
SOUTH LAPORTE	"	16
SUNNYSIDE	ASH ST.	10
"	ELM ST.	"
"	MARQUETTE ST.	"
"	PINE ST.	"
"	OAK ST.	"
"	WALNUT ST.	"
WESTWOOD PLACE	BUTTERNUT DR.	10
"	CHESTNUT DR.	"
"	LARCH LN.	"
COZY ACRES	PEPPERIDGE DR.	"
WROBEL	REDBUD DR.	32
"	WESTWOOD DR.	4

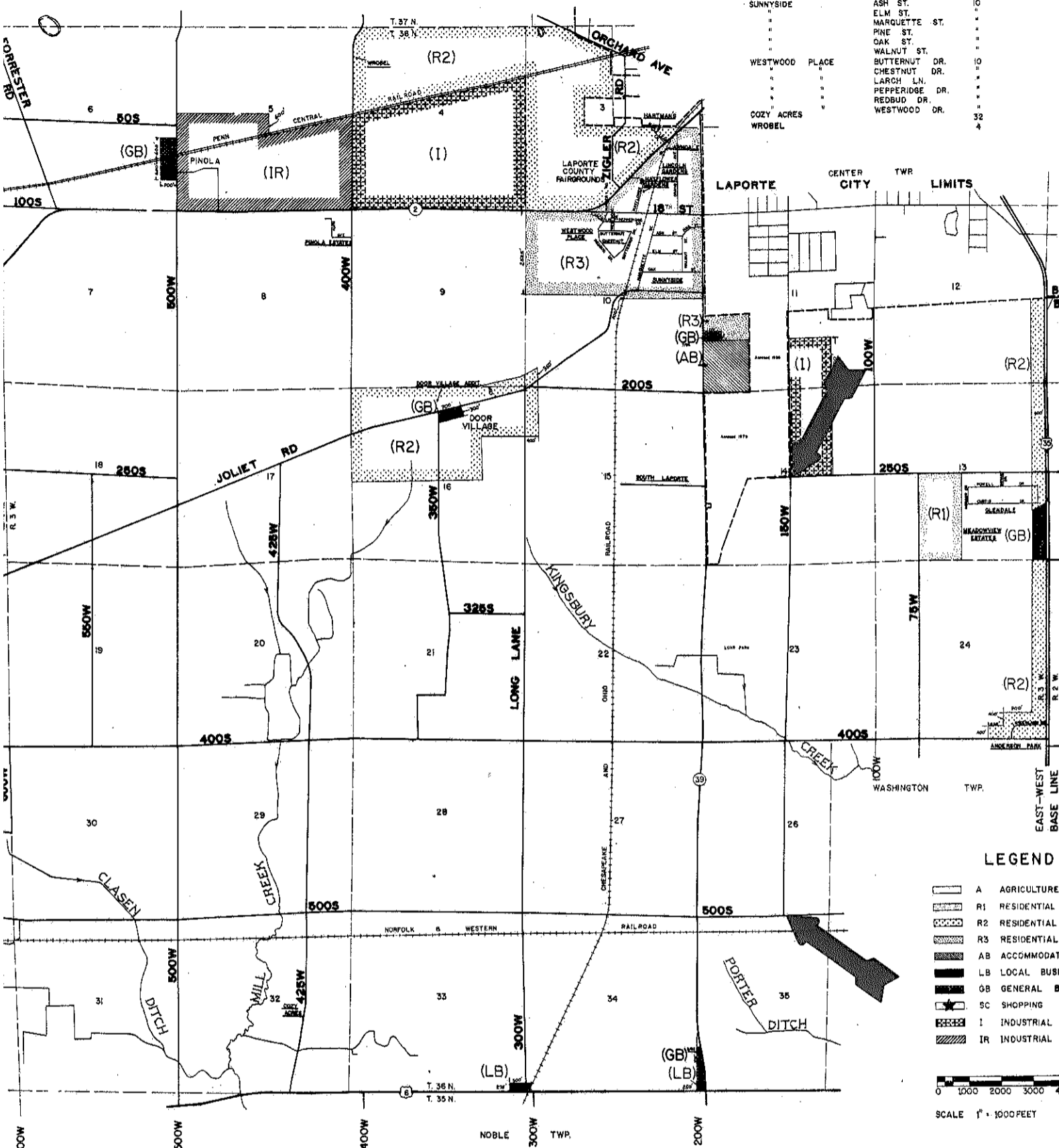

LEGEND

- A AGRICULTURE
- R1 RESIDENTIAL
- R2 RESIDENTIAL
- R3 RESIDENTIAL
- R2 RESIDENTIAL
- AB ACCOMMODAT
- LB LOCAL BUSIN
- GB GENERAL BU
- SC SHOPPING CE
- I INDUSTRIAL
- IR INDUSTRIAL P

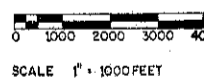

# SCIPPIO TOWNSHIP

## LAPORTE COUNTY, INDIANA

### ZONING MAP

