

ORDINANCE OF THE LAPORTE COUNTY
BOARD OF COMMISSIONERS
NO. 94-15

WHEREAS, the Board of Commissioners of LaPorte County is responsible for formulating County Road policy consistent with the Statutes of the State of Indiana; and,

WHEREAS, the Board of Commissioners of LaPorte County recognize that a hazardous situation exists and have decided, therefore, that it is necessary to establish a thirty (30) miles per hour speed zone on Rolling Drive, Meadowlark Drive, and Oakdale Drive, in North View Subdivision off Ludlow Street in unincorporated Rolling Prairie in Kankakee Township; and,

WHEREAS, the Board of Commissioners of LaPorte County have the authority under Indiana Code 9-21-5-6 to establish the rate of speed on designated roadways;

IT IS THEREFORE ORDAINED:

1. That pursuant to Indiana Code 9-21-5-6 it shall be unlawful for any vehicle to exceed thirty (30) miles per hour on Rolling Drive, Meadowlark Drive, and Oakdale Drive, in North View Subdivision off Ludlow Street in unincorporated Rolling Prairie in Kankakee Township;
2. That the LaPorte County Highway Department is hereby directed and ordered to post said road with signs indicating Thirty (30) miles per hour;
3. That after the roadway has been posted in accordance with paragraph 2, herein, it shall be an infraction under Indiana Code 9-21-5-6 for any person to violate this ordinance.

Passed this 1st day of August, 1994.

BOARD OF COUNTY COMMISSIONERS
LAPORTE COUNTY, INDIANA

Michael T. Quinn
Michael T. Quinn, President

Norman E. Pahs
Norman E. Pahs

Stephen J. Wurster

Attest: Michael R. Schultz
Michael R. Schultz, County Auditor

By: Diane S. Richards
Chief Deputy Auditor

Please publish two (2) times in the Michigan City News-Dispatch and the LaPorte Herald-Argus on Monday, August 8, 1994 and Monday, August 15, 1994.

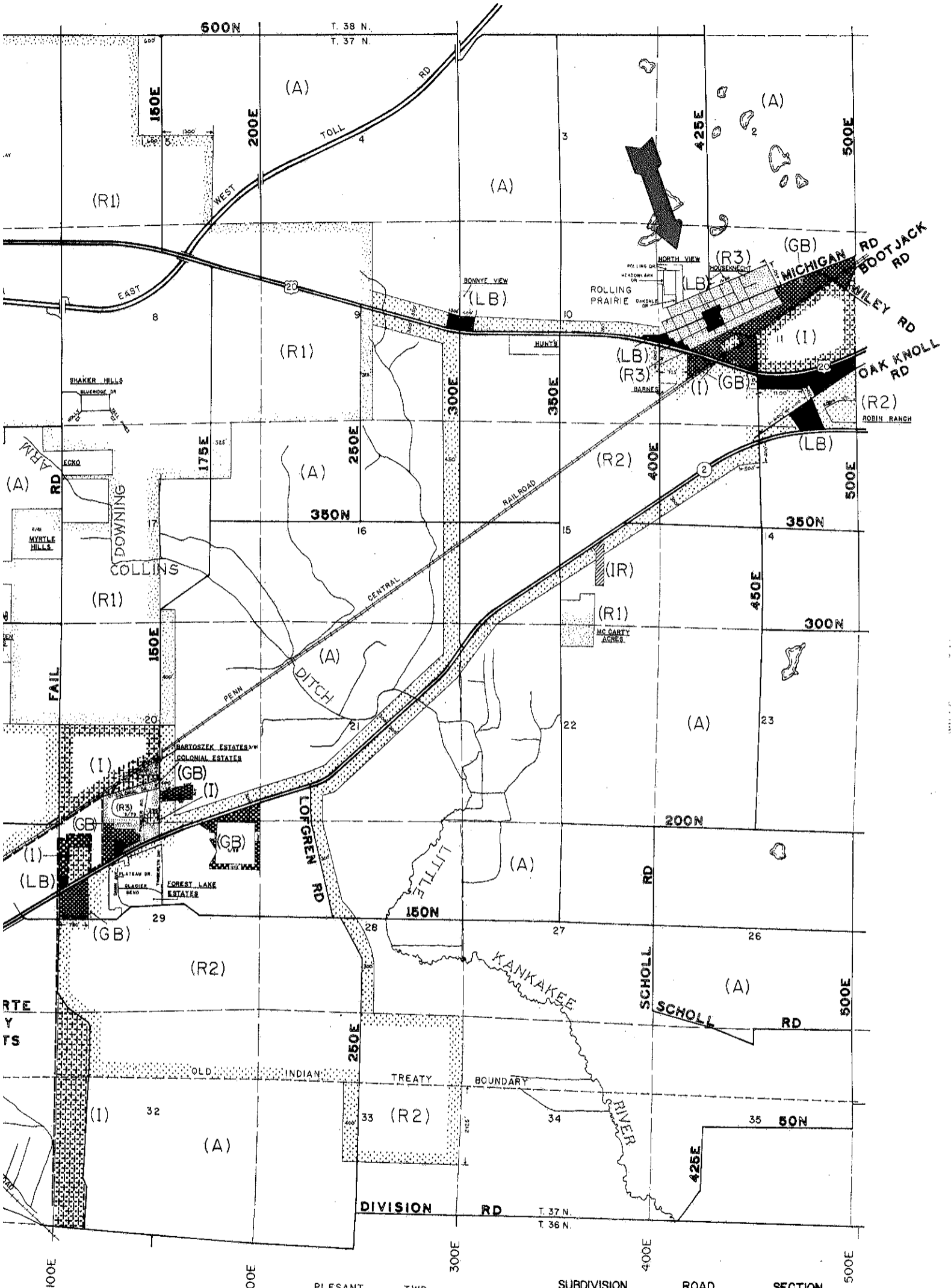

SECTION

IVE.	10
BEND	29
U DR.	"
	10
	15 & 22
	18
LARK DR.	11
E DR.	"
I DR.	"
ST.	11
GE DR.	8
CT.	"
INES CT.	"

LEGEND

(Blank)	A	AGRICULTURE
(Stippled)	R1	RESIDENTIAL
(Dotted)	R2	RESIDENTIAL
(Cross-hatched)	R3	RESIDENTIAL
(Diagonal lines)	AB	ACCOMMODATION BUSINESS
(Solid black)	LB	LOCAL BUSINESS
(Checkered)	GB	GENERAL BUSINESS
(Star in circle)	SC	SHOPPING CENTER

SUBDIVISION	ROAD	SECTION
COLONIAL EST.	PIONEER RD.	20
"	COLONIAL DR.	20
ECKO	"	17
EVERGREEN EST.	"	19
HOUSEKNECHT	"	11
RANGWOOD	BARCLAY	6
"	CAMERON	6
"	STEWART	6



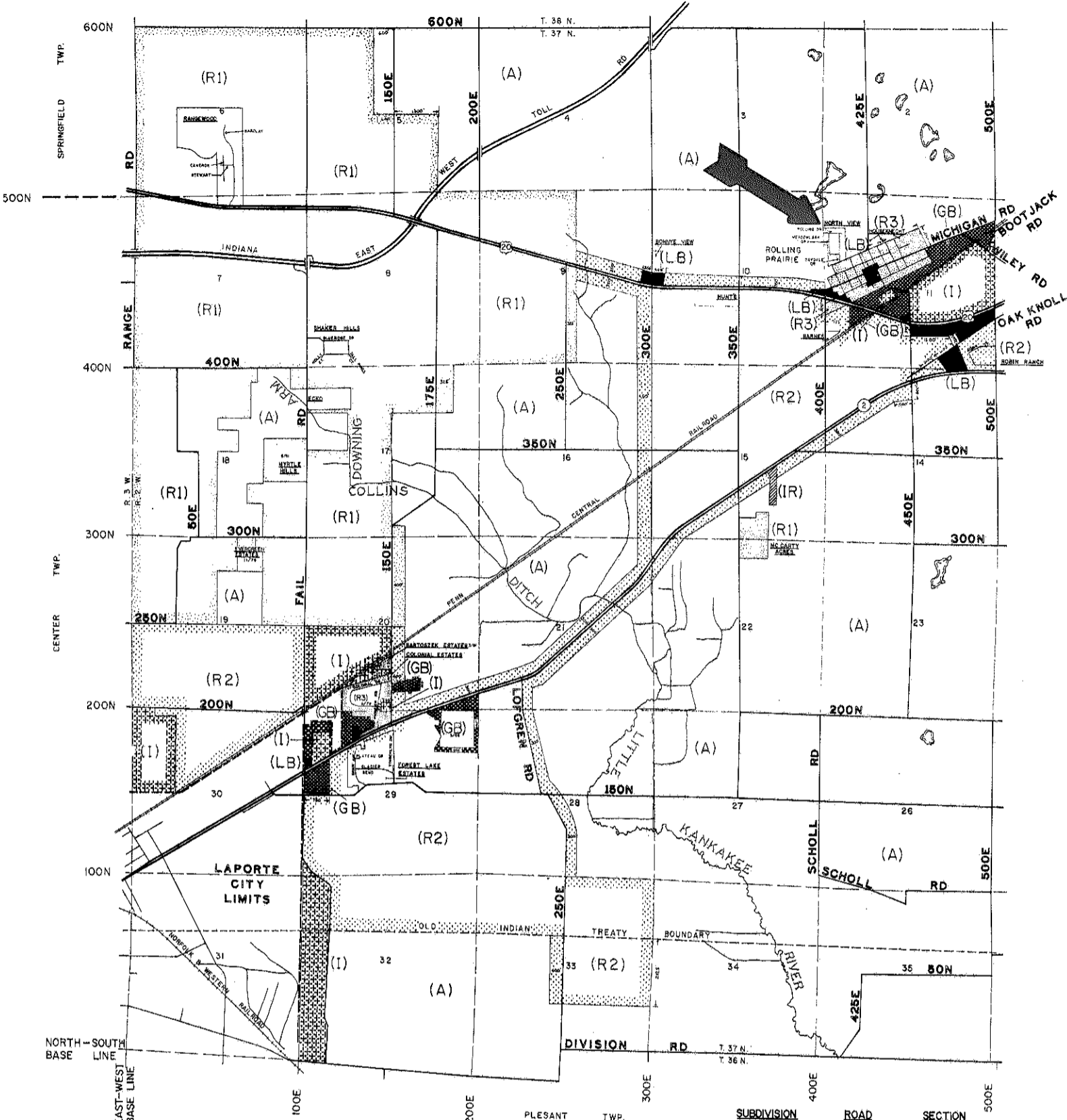

SUBDIVISION	ROAD	SECTION
BONNYE VIEW	DAWN AVE.	10
FOREST LAKE ESTS.	GLACIER BEND	29
"	PLATEAU DR.	"
"	"	"
HUNT'S	"	10
MC CARTY ACRES	"	15 & 22
MYRTLE HILLS	"	18
NORTH VIEW	MEADOWLARK DR.	11
"	OAKDALE DR.	"
"	ROLLING DR.	"
ROBIN RANCH	ROBIN CT.	11
SHAKER HILLS	BLUERIDGE DR.	6
"	HOLLY CT.	"
"	TALL PINES CT.	11
BARNES	"	20
BARTOSZEK ESTATES	"	"

SUBDIVISION	ROAD	SECTION
COLONIAL EST.	PIONEER RD.	20
"	COLONIAL DR.	20
ECKO	"	17
EVERGREEN EST.	"	19
HOUSEKNECHT	"	11
RANGEWOOD	BARCLAY	6
"	CAMERON	6
"	STEWART	6

LEGEND

- A AGRICULTURE
- R1 RESIDENTIAL
- R2 RESIDENTIAL
- R3 RESIDENTIAL
- AB ACCOMMODATION BUSINESS
- LB LOCAL BUSINESS
- GB GENERAL BUSINESS
- SC SHOPPING CENTER
- I INDUSTRIAL
- IR INDUSTRIAL RESERVE

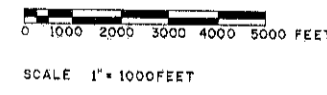

KANKAKEE TOWNSHIP

LAPORTE COUNTY, INDIANA

ZONING MAP

